

Digital balancing machine for car, light commercial vehicle, 4-WD, motorcycle and scooter wheels.

 **Explora**  
werkplaats optimalisatie



**AWA**

Automatic  
Width Approximation

**VDD**

Virtual Direct Drive  
(CEMB patent)

**quick**  
**accurate**  
**reliable**



**CEMB**

BALANCING MACHINES

**C71 EVO**

# C71 EVO

**quick**  
**accurate**  
**reliable**

Universal space saving wheel balancer with excellent technical specifications, combining a sturdy structure with attractive and modern design.

All types of steel or light alloy wheels for cars, off-road vehicles and light commercial vehicles, motorcycles and scooters can be balanced with high precision by standard and optional adaptors.

The new and exclusive VDD measuring (Virtual Direct Drive - CEMB patent) to obtain reliable unbalance measures in a short time, nearly half the cycle time respect to other balancers in this range.

“Intelligent” gauge for automatic measurement of distance and diameter.

AWA (Automatic Width Approximation – CEMB patent). Sufficiently accurate to balance correctly most of the wheels. Reduces the time of setting, by calculating the most probable width automatically.

Position repeater for counterweight application (with display on panel).

Pincer system to hold and apply counterweight inside the rim.

Pedal stationary brake to maintain the wheel during the locking/unlocking or during the correction of unbalance.

Balancing with counterweight placed in different positions of the rim, freely selected on panel. SPLIT program to hide counterweights behind rim spokes, in any angular layout.

Duplication of split weight positions.

Menu button for selection of various options and personalization (grams/ounces; inches/millimeters; unbalance in steps of 5 grams or 1 gram; threshold, optimization; automatic start; self-diagnosis and self-calibration).

Minimization of the static unbalance (CEMB patent), very useful to reduce vibrations caused by residual unbalances after counterweight application.

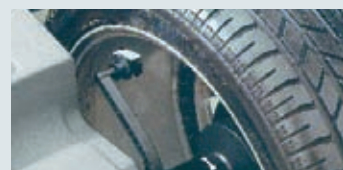

**ALU-S**



**SPLIT**



**guaranteed accuracy**

The balancer utilizes special devices WP (Warranted Precision), for both hardware and software, to guarantee the quality of measurement. The display only occurs when the measuring indecision (according to DIN 1319) is less than 1 gram, in the minimum necessary time.

Automatic set-up for hidden weights.



Counterweight position set-up.



Position repeater display for internal counterweight application.



Split program display for spoked wheels.



Duplication of split weight positions.



Optimization of rim-tyre position.



## ► Dati tecnici

Single phase power supply	230 V - 50/60 Hz (on request 115 V)
Max. absorbed power	0,8 Kw
Balancing speed	< 100 rpm
Balancing accuracy	< 1 g
Diameter setting range	10" ÷ 30" or 265 ÷ 765 mm
Rim width setting range	1,5" ÷ 20" or 40 ÷ 510 mm
Max. wheel weight	80 Kg
Gross weight (with fittings and wheel guard)	137 Kg
Packing dimensions	101 x 112 x 174 cm

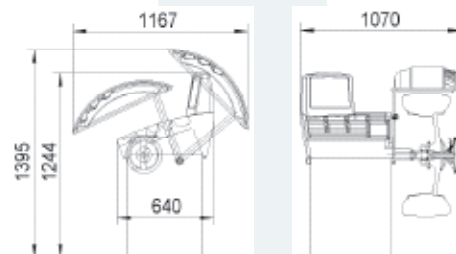

## ► Accessories

standard

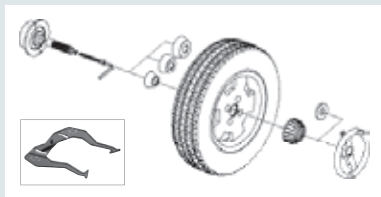

- **UC20/2 cone adaptor** with **GPM** quick locking with handwheel for wheels with central hole Ø from 43 to 110 mm.
- **Gauge** for wheel width measurement.

options to be used with the cone adaptor

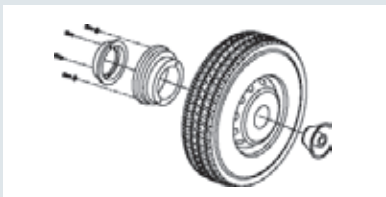

- **VL/2 cone kit** necessary to lock light truck wheels with central hole Ø from 97 to 180 mm.

## Options to be used with the cone adaptor



- **RL hollow sleeve** Ø 206 mm, for alloy rims.

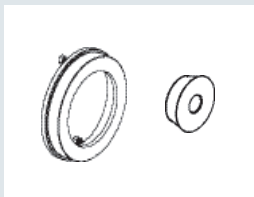

- **WD spacer** for car wheels with deep off-set and for off-road wheels.

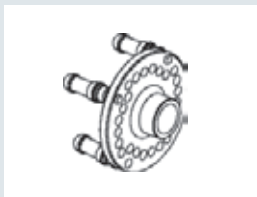

- **Adapters with SR** centering studs: **SR standard**.

- **MT stepped cone** for German car rims (Ø 56,5 - 57 - 66,5 - 72,5 mm).

- **J cone** for off-road vehicle with hole Ø 101 to 119 mm.

## options

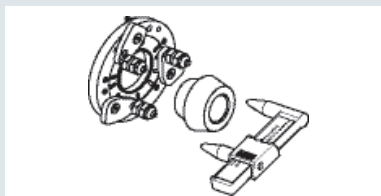

- **UH20/2** for wheels with 3-4-5 holes, with/without central hole on a Ø from 95 to 210 mm. The additional cone (CEMB patent), in the majority of cases, allows to center the wheel from inside on the central hub seat, thus improving balancing accuracy respect to the traditional adaptors on the market.

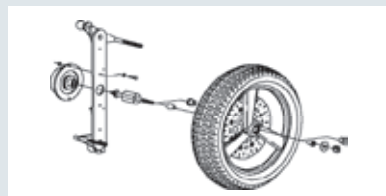

- **RMC20 MOT/2** universal adaptor for standard and flanged or side hung motorcycle wheels (BMW - Aprilia - Honda - Ducati - etc.) and scooter wheels.



- **Pincer-hammer** for counterweights.



- **Wheel guard** not compulsory (<100 rpm). Optional as splash-guard.

Some of our customers:



# CEMB

BALANCING MACHINES



**CEMB S.p.A.**

Via Risorgimento, 9  
23826 Mandello del Lario (LC) Italy  
www.cemb.com



**Garage equipment division:**

phone +39 0341 706369  
fax +39 0341 700725  
garage@cemb.com

**CEMB USA**

**BL Systems Inc.**

2873 Ramsey Road  
Gainesville, GA 30501 - USA  
Phone +001 678 717 1050  
Fax +001 678 717 1056  
sales@cemb-usa.com

Maxwellstraat 4 - 6716 BX EDE  
Postbus 300 - 6710 BH EDE  
T. 0318 - 648 220  
F. 0318 - 648 245  
I. www.explora.nl  
E. info@explora.nl

All the data and features mentioned in this catalogue are purely for information and do not constitute any commitment on the part of our company, which reserves the right to make any and all alterations it may consider suitable without notice.